

A NEW CHAPEL

Worship is one of the most universal and effective expressions of Episcopal identity and community life. When we gather for worship, we immerse ourselves in the traditions, stories, and values that serve as the anchors of our community, seeking to center our hearts and minds around the love of God revealed to us in the person of Jesus Christ.

Placed at the front of campus, the new chapel will serve as a visual representation of Porter-Gaud's commitment to our Episcopal identity and how we live out our mission and core values.

Mindfully designed in the style of the original St. Timothy's Chapel on the former Porter Military Academy campus, the new chapel will seat 600 people and create unlimited opportunities for fellowship, discussion, contemplation, and worship. With faith as its core purpose, this new full-sized chapel will be a sacred space dedicated to awakening, enlightening, and nurturing the spirits of all who enter.

The Vision

- + Strengthen the spiritual development of students in all divisions.
- + Enter into the beautiful liturgy of the Anglican tradition as it was meant to be.
- + Immerse ourselves in the traditions, stories, and values that anchor us.
- + Welcome speakers, hold concerts, and host community-building events.
- + Create a haven where God's love for His children is ever-present.

The Project

- + Increase square footage from 1,110 to 7,884.
- + Design a beautiful sanctuary space that prepares hearts and minds for worship.
- + Construct a redesigned WATCH tower to honor our founder, The Rev. Dr. Anthony Toomer Porter.
- + Add a multi-purpose room for meetings, fellowship, and ministry opportunities.
- + Build a tranquil garden and terrace space for reflection and prayer.
- + Provide two new classroom spaces and three chaplain's offices.
- + Increase seating capacity for school gatherings to accommodate an entire division and staff.
- + State-of-the-art acoustics, A/V, and lighting.



NAMING OPPORTUNITIES

AVAILABLE

| | |
|-------------------------|-----------|
| WATCH Tower | \$750,000 |
| Sanctuary Space | \$500,000 |
| Annex | \$250,000 |
| Altar | \$200,000 |
| Balcony | \$150,000 |
| Vesting Room | \$75,000 |
| Vestry Storage | \$25,000 |
| Pews First Floor | \$20,000 |
| Pews Balcony | \$15,000 |

ALREADY PURCHASED

- 9 Pews
- 3 Chaplains Offices
- 1 Pulpit
- 2 Classrooms
- 1 Kitchen
- 1 Narthex
- 1 Sacristy

Proposed Square Footage: 7,884

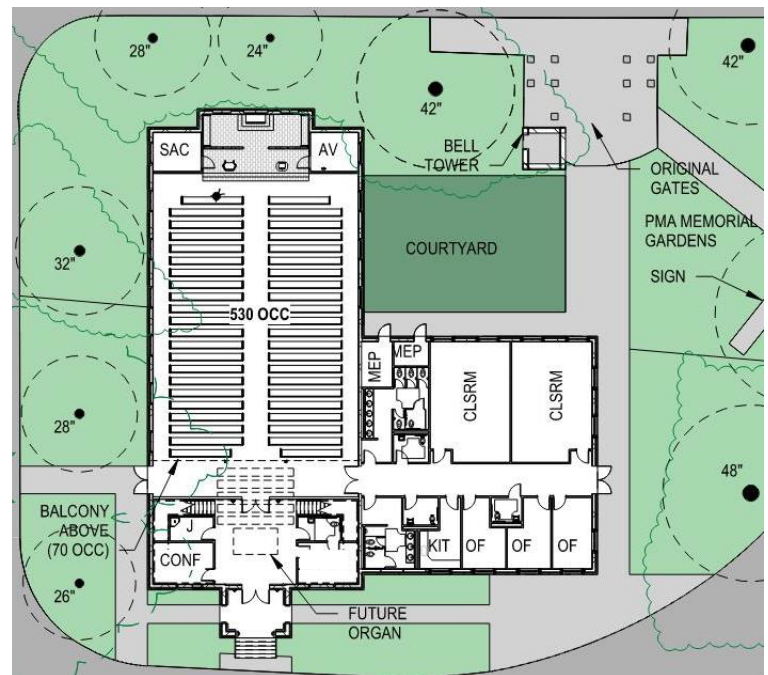

- 1 Portico
- 1 Garden
- 1 Center Altar Stained Glass
- 2 Stained Glass
- 1 Conference Room
- 1 Baptismal Font

If you are interested in being a part of this project, please contact:

Lisa Ward | lward@portergaud.edu | 843.402.4754 or **Craig Stewart** | cstewart@portergaud.edu | 843.402.4690

["For where two or three gather in my name, I am there with them." Matthew 18:20]